



Growing to Serve

A \$15 MILLION CAPITAL CAMPAIGN FOR
A NEW ACHIEVEMENT CENTER

(ADULT DAY PROGRAM)

Mission

New Concepts for Living (NCFL) is dedicated to enriching the lives of adults with special needs through caring and compassionate support within a nurturing environment that promotes independence, growth, and inclusion.



Who We Are

NCFL is a community-based not-for-profit dedicated to serving and empowering individuals with special needs (intellectual and developmental disabilities) while giving desperately needed respite to their families.

NCFL was formed in 1981 by a group of parents with developmentally disabled children who were transitioning into adulthood. Recognizing the lack of services and day programs for adults with special needs, NCFL was created to ensure that this demographic had access to essential enrichment programs and services enabling them to thrive.

NCFL offers comprehensive support for all participants, including housing, day programs, and therapeutic services, all in a nurturing environment. Our array of programs and services not only fosters the development of social skills and intellectual growth, but also empowers individuals to realize their fullest potential.

NCFL operates 17 Community Residences (group homes) and an Achievement Center (day program) in Rochelle Park, NJ. All of our Community Residences have direct support professionals on site 24/7, providing our participants with around-the-clock care.

NCFL'S TIMELINE

1981-1985
Founded

NCFL is founded in 1981 by several parents of children with special needs who are transitioning into adulthood.

The first Community Residence (group home) is opened in Hillsdale, NJ in 1985. This home remains open today.

1990-1996

NCFL expands the number of Community Residences with the opening of homes in Teaneck, Park Ridge, River Vale and River Edge.

1999-2012

NCFL moves their Achievement Center to a larger space in Rochelle Park to accommodate the rise in participants.

In response to a greater demand for Community Residences, NCFL opens homes in Clifton, Garfield, and Emerson.

2016-2020

NCFL opens Community Residences in Haledon, Northvale and two in Mahwah.

Recognizing the desperate need for housing for adults with special needs requiring 24/7 medical support, NCFL acquires four lots for the purpose of building Medically Supportive Residences.

2021 - 2023

NCFL opens Medically Supportive Residences in River Vale and two in Old Tappan.

Construction begins on two more Medically Supportive Residences.

NCFL owns and operates 17 Residences with plans to open five additional homes in 2024.

PRESENT

Construction is under way for an 81,000 sq ft state-of-the-art Achievement Center in Paramus, NJ. The construction of this much larger Center is due to the extremely high demand for our day program and therapeutic services. NCFL's waiting list currently stands at approximately 300 individuals and our goal is to accommodate all those seeking our services.



STATEMENT OF NEED

Over the last 42 years, NCFL's growth and unwavering dedication have positioned us as the leading agency providing compassionate and comprehensive care for adults with special needs.

The Achievement Center at NCFL provides essential programs and services that adults with special needs rely on for a fulfilling life. Our day program enables participants to enhance and develop their skill set, to be more independent, to participate in group activities, and to engage with the community.

As children with special needs transition into adulthood, families seek comprehensive day programs that can fill their days with valuable enrichment activities. Unfortunately, many agencies offering such services fall short of providing the level of care that NCFL offers or have long waiting lists. NCFL alone has a waiting list of approximately 300 individuals and growing.

The high demand for our services, coupled with the need for a significantly larger staff to accommodate the increase in participants, led NCFL to search for a more spacious facility to support and sustain this remarkable growth.



There are significant benefits for adults with disabilities who participate in a day program, including improved mental and emotional well-being, the opportunity to build relationships, enhanced independence, access to expanded disability support and resources, and community inclusion. Engagement in a day program has proven to reduce anxiety, depression, and loneliness. It also offers desperately needed respite for caretakers, allowing them to work and attend to their own needs. NCFL's day program focuses on enriching participants' lives while giving peace of mind to their loved ones.

Having outgrown our Rochelle Park Achievement Center, NCFL responded to the need for a larger space by purchasing a significantly larger facility (81,423 square feet) on Route 17 in Paramus, NJ. Our new Achievement Center is being custom-built, incorporating unique design enhancements tailored to the needs of our population, with plans for on-site physical, occupational, behavioral, and speech therapy. It will also include programs and dedicated spaces highlighting prevocational skills to assist those able to work in the community. This new space will increase our ability to serve adults with special needs more than three-fold.

When completed in the Spring of 2024, NCFL's new Achievement Center will be the only one of its kind in the nation and serve as a model for all others in the field to follow.

GROWING TO SERVE

A \$15M CAMPAIGN FOR
A NEW
ACHIEVEMENT
CENTER

Opening in Spring 2024



Ground Floor



Top Floor



Naming Opportunities

Naming opportunities offer corporations or families the chance to contribute to a noteworthy chapter in NCFL's story, becoming an integral part of our lasting legacy. Your contribution will be prominently acknowledged at our new, cutting-edge Achievement Center.

The following pages list naming opportunities which can be paid in one installment or via a pledge for payment over several years.

Ground Floor:

- Behavioral Wing
- Medically Fragile Wing
- Town Square & Main Street
- Non-Behavioral Wing

Top floor:

- Vocational Training
- OT/PT/Speech Therapy
- Fitness Center
- Board Room
- Staff Training Rooms
- Library
- Legal Office

ACHIEVEMENT CENTER

TBD

81,423 Square Feet
Limited to one sponsor

Establish a legacy by securing the entire facility's naming rights for 5 years. When completed, this 81,423-square-foot multilevel center will house:

- Three Distinct Day Habilitation Programs (Behavioral, Non-Behavioral & Medically Fragile)
- 5500 Sq. Ft. Community Center/Town Square
- Spacious Main Street & Walking Paths
- Extensive Covered Drop-off/Pick-up Area
- Life Skills Training Rooms
 - Kitchen, Supermarket, Bedroom, Laundry
- Multiple Sensory Rooms
- Computer and Technology Lab
- Occupational Therapy
- Physical Therapy
- Speech Therapy
- Prevocational Training
- Medical Suite
- Nurse's Suite
- Recreation & Fitness Space
- Two Staff Training Centers



Building prior to new construction

ACHIEVEMENT CENTER

Area Stats:

Location: 765 Route 17 South, Paramus, NJ

Building Size: Approx. 81,423

Population

1 Mile 10,358

5 Miles 319,628

10 Miles 1,358,525

Average Daily Traffic - 138,000 vehicles



Occupying a prime location, this state-of-the-art and one of a kind facility boasts unparalleled visibility, capturing the attention of passersby and creating a commanding presence in Bergen County, NJ. Its strategic positioning ensures maximum exposure from both sides of Rte. 17 and its six acre lot stands out in the bustling landscape on Rte. 17.

The expansive windows and well-designed layout further enhance the property's visibility, allowing natural light to flood the space and showcase its features. This building is a true gem for those who value prominence and visibility in a premium setting.

BEHAVIORAL WING

\$350,000

14,002 Square Feet

Limited to one sponsor

INCLUDES:

- Naming rights for 4 years
- One large common area - approx. 1,450 square-footage
- Nine work rooms - approx. 7,467 total square-footage
- Two sensory rooms

Pink Area

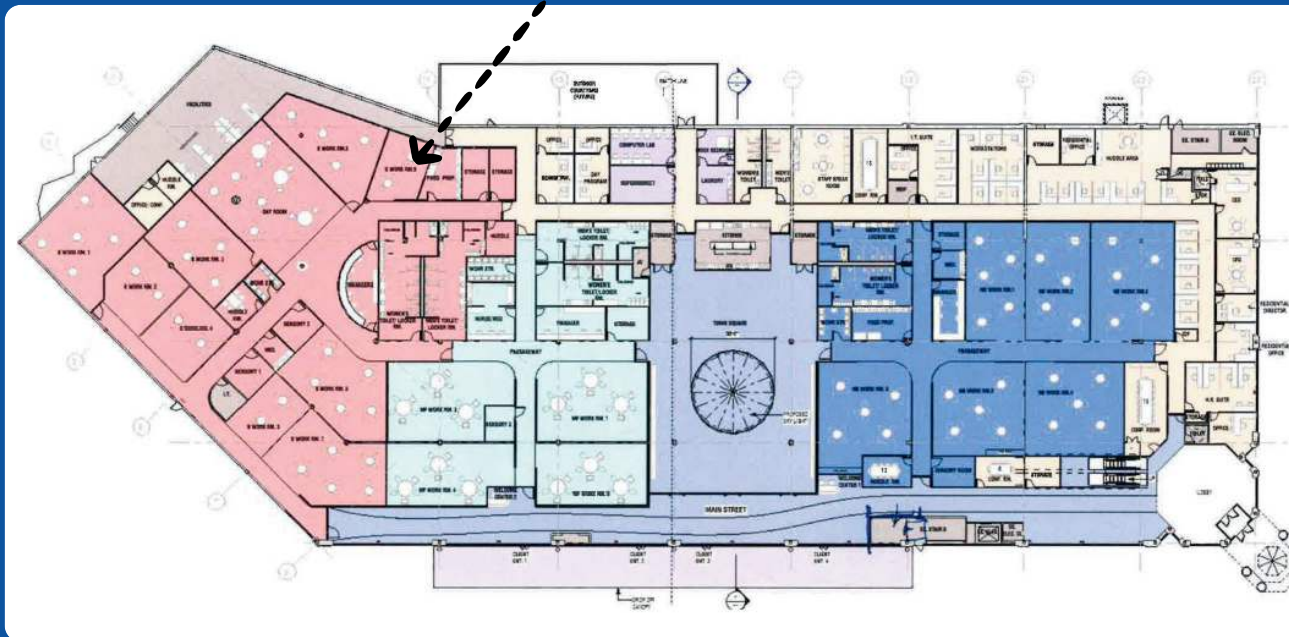

NON-BEHAVIORAL WING

\$250,000

10,528 Square Feet
Limited to one sponsor

INCLUDES:

- Naming rights for 3 years
- Six work rooms - approx. 6,050 total square-footage
- Sensory Room
- Huddle Room
- Food Prep Room

Blue Area

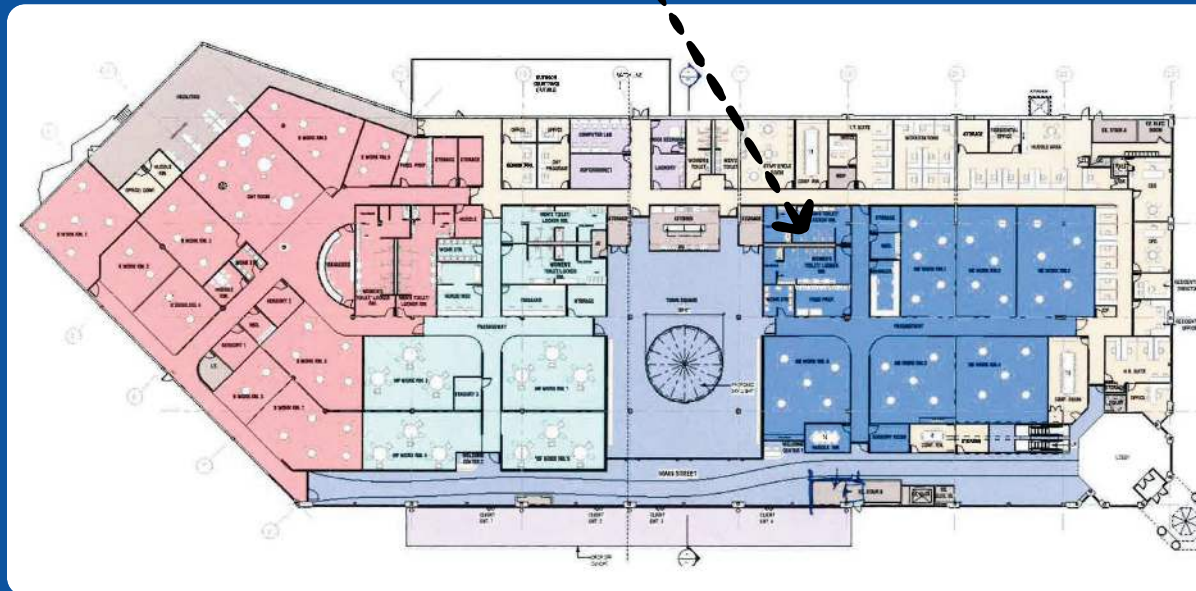

TOWN SQUARE AND MAIN STREET

\$250,000

7,000+ Square Feet

Limited to one sponsor

NCFL's Town Square is centrally located on the lower level of the Achievement Center with 6,045 square feet of open space for client meetups, companywide gatherings, etc. This area faces 'Main Street' where there will be several entrances for clients and staff, and is surrounded by the Medically Fragile and Non Behavioral wings.

Naming rights are for 3 years.

Lavender Area

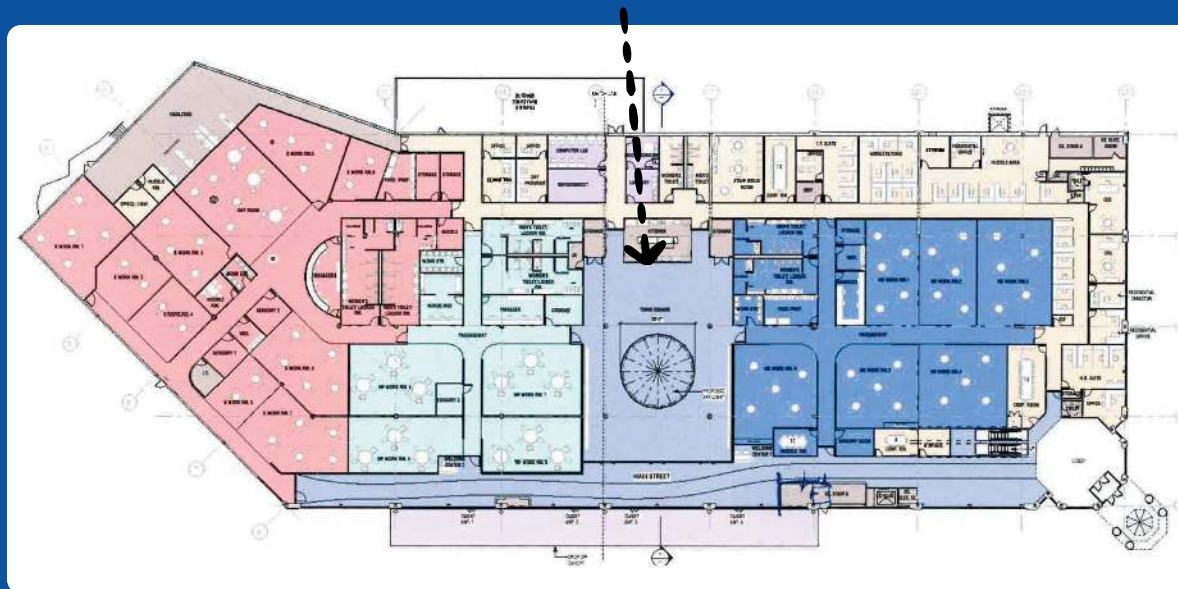

MEDICALLY FRAGILE WING

\$200,000

7,886 Square Feet
Limited to one sponsor

INCLUDES:

- Naming rights for 2 years
- Four Work Rooms - approx. 4,015 Total square-footage
- Nurse/physician office

Turquoise Area

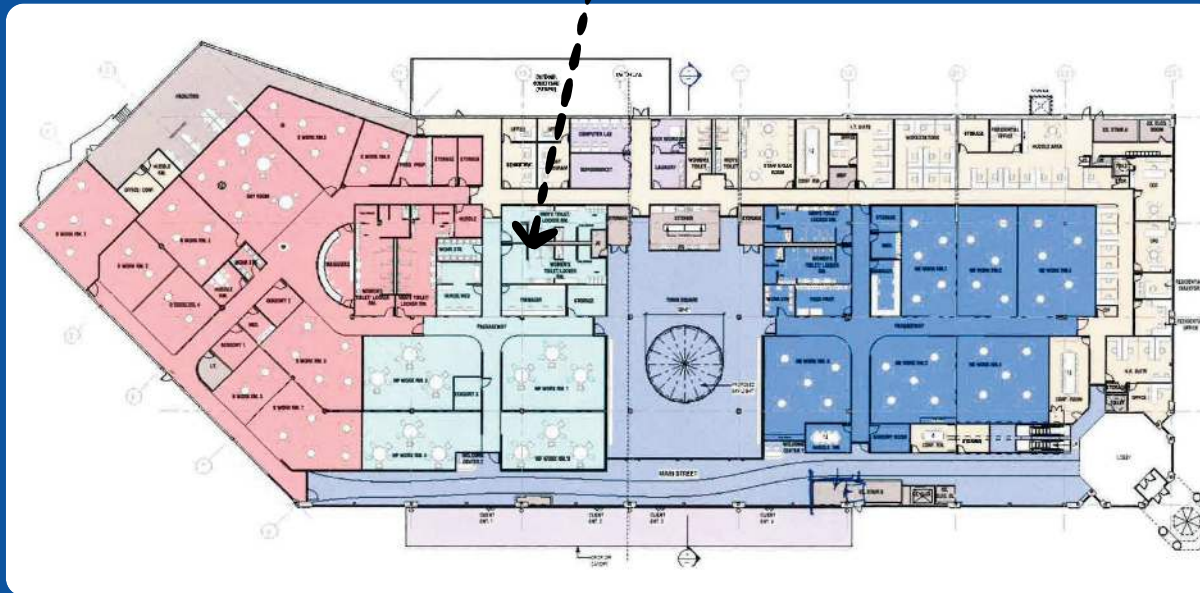

Additional Naming Opportunities

(All naming rights below are for two years and must be paid in full in first year)

Lobby and Welcome Area
\$200,000

Board Room
\$150,000

Conference Room
2 @ \$150,000

Kitchen
\$125,000

Computer Lab
\$125,000

Supermarket
\$125,000

Behavioral
Work Rooms
9 @ \$100,000

Medically Fragile
Work Rooms
4 @ \$100,000

Non-Behavioral
Work Rooms
6 @ \$100,000

Fitness Center
\$75,000

Staff Training Room
2 @ \$75,000

Sensory Room -
Non-Behavioral
\$75,000

Sensory Room -
Behavioral
2 @ \$75,000

Sensory Room -
Medically Fragile
\$75,000

Laundry or Bedroom
Life Skills Rooms
\$75,000

Digital Donor Wall

All donations at \$25,000 and above will also receive annual recognition on a "Digital Donor Wall" located within the Achievement Center.



New Concepts for Living

*Providing a Lifetime of Care
for Extraordinary People*

Community
Residences
(Group Homes)



Medically
Supportive
Community
Residences



Achievement
Center
(Day Program)



Behavioral
& Nursing
Services



Be part of our family...

Where extraordinary people thrive.

For more information please call Sharon Scimeca, Director of Development at 551-733-6349 or via email at sscimeca@ncfl.net

"Joey has been attending NCFL's day program for 15 months now; it's been a great adult transition for him. It is wonderful as parents to know he is safe and happy creating wonderful memories each day. I see this each afternoon at pickup time when Joey's friends assist the staff in leading him out of the workrooms - the bond he's created with other clients is amazing. It warms a mom's heart to hear other clients and staff cheer his name to greet him.

We love the opportunities he's had in the community with the numerous outings and the accessibility of wheelchair vans that are always available for him. With full time nurses in the program and Joey's medical needs, it also adds to the reassurance that he is in good hands. As a family we always feel welcome at their many events. They offer a full calendar of activities for life skills and academic skills to be sharpened, as well as art, dance and music to keep him well rounded. We are blessed to have the NCFL family be part of ours!"

Kim C. - Joey's Mom