



Growing to Serve

A \$15 MILLION CAPITAL CAMPAIGN FOR
OUR NEW ACHIEVEMENT CENTER
(ADULT DAY PROGRAM)



Mission

New Concepts for Living (NCFL) is dedicated to enriching the lives of adults with special needs through caring and compassionate support within a nurturing environment that promotes independence, growth, and inclusion.



Who We Are

NCFL is a community-based not-for-profit dedicated to serving and empowering individuals with intellectual and developmental disabilities (I/DD) while giving desperately needed respite to their families.

NCFL was formed in 1981 by a group of parents with developmentally disabled children who were transitioning into adulthood. Recognizing the lack of services and day programs for adults with special needs, NCFL was created to ensure that this demographic had access to essential enrichment programs and services enabling them to thrive.

NCFL offers comprehensive support for all participants, including housing, day programs, and behavioral, nursing and therapeutic services, all in a nurturing environment. Our array of programs and services not only fosters the development of social skills and intellectual growth, but also empowers individuals to realize their fullest potential.

NCFL operates 18 Community Residences (4 designed for medically fragile individuals) and an Achievement Center in Paramus, NJ. All of our programs and residences have direct support professionals on site 24/7, providing our participants with around-the-clock care.

NCFL'S TIMELINE

1981-1985
Founded

NCFL is founded in 1981 by several parents of children with special needs who are transitioning into adulthood.

The first Community Residence (group home) is opened in Hillsdale, NJ in 1985. This home remains open today.

1990-1996

NCFL expands the number of Community Residences with the opening of homes in Teaneck, Park Ridge, River Vale and River Edge.

1999-2012

NCFL moves their Achievement Center to a larger space in Rochelle Park to accommodate the rise in participants.

In response to a greater demand for Community Residences, NCFL opens homes in Clifton, Garfield, and Emerson.

2016-2020

NCFL opens Community Residences in Haledon, Northvale and two in Mahwah.

Recognizing the desperate need for housing for adults with special needs requiring 24/7 medical support, NCFL acquires four lots for the purpose of building Medically Supportive Residences.

2021 - 2023

NCFL opens Medically Supportive Residences in River Vale and two in Old Tappan.

Construction begins on two more Medically Supportive Residences.

NCFL owns and operates 18 Residences with plans to open four additional homes in 2024.

PRESENT

NCFL's new, 81,423 sq ft state-of-the-art Achievement Center opens its doors in Paramus, NJ on June 18th. This much larger Achievement Center will allow us to serve 3x the number of individuals we currently serve, enabling us to accept many of those on our 300+ waiting list. Services offered at the new day program include dedicated wings for high-need, low-need and medically fragile individuals; P/T, O/T and speech therapy; 24/7 nurses and behaviorists; life-skills training rooms; and prevocational training.



STATEMENT OF NEED

Over the last 42 years, NCFL's unwavering dedication to providing compassionate and comprehensive care for adults with special needs has positioned us as the leading agency providing these services in New Jersey.

NCFL's Achievement Center provides essential programs and services that adults with special needs rely on for a fulfilling life. Our day program enables participants to enhance and develop their skill set, to be more independent, to participate in group activities, and to engage with the community.

As children with special needs transition into adulthood, families seek comprehensive day programs that can fill their days with valuable enrichment activities. Our day program provides an unmatched activities calendar, well-rounded skills training, and on-site behavioral and nursing services for all our day program participants. Our program includes day trips to fun and exciting places of interest, arts and crafts activities, board and video games, karaoke, as well as classes like adapted karate, yoga, swim, and dance. All programs and activities are intended to stimulate the mind, increase social and motor skills, increase community inclusion, and develop imagination.

The high demand for our services, coupled with the need for a significantly larger staff to accommodate the increase in participants, led NCFL to search for a more spacious facility to support and sustain this remarkable growth.



There are significant benefits for adults with disabilities who participate in a day program, including improved mental and emotional well-being, the opportunity to build relationships, enhanced independence, access to expanded disability support and resources, and community inclusion. Engagement in a day program has proven to reduce anxiety, depression, and loneliness. It also offers desperately needed respite for caretakers, allowing them to work and attend to their own needs. NCFL's day program focuses on enriching participants' lives while giving peace of mind to their loved ones.

Having outgrown our Rochelle Park Achievement Center, NCFL responded to the need for a larger space by purchasing a significantly larger facility (81,423 square feet) on Route 17 in Paramus, NJ. Our new Achievement Center was custom-built, incorporating unique design enhancements tailored to the needs of our population, with on-site physical, occupational, behavioral, and speech therapy. It also includes programs and dedicated spaces highlighting prevocational skills to assist those able to work in the community. This new space increases our ability to serve adults with special needs more than three-fold.

NCFL's new Achievement Center is the only one of its kind on the East Coast, and serves as a model for all others in the field to follow.

GROWING TO SERVE

A \$15M CAMPAIGN FOR OUR NEW ACHIEVEMENT CENTER



This New State-of-the-Art Achievement Center (Day Program) Will Include:

- Three Distinct/Separate Day Habilitation Programs
- 5500 Sq. Ft. Community Center/Town Square
- Spacious Main Street & Walking Paths
- Extensive Covered Drop-off/Pick-up Area
- Life Skills Training Rooms
 - Kitchen, Supermarket, Bedroom, Computer Lab, and Laundry
- Multiple Sensory Rooms
- Occupational Therapy
- Physical Therapy
- Speech Therapy
- Prevocational Training
- Wellness Suite
- Nurse's Suite
- Recreation & Fitness Space
- Two Staff Training Centers

Ground Floor

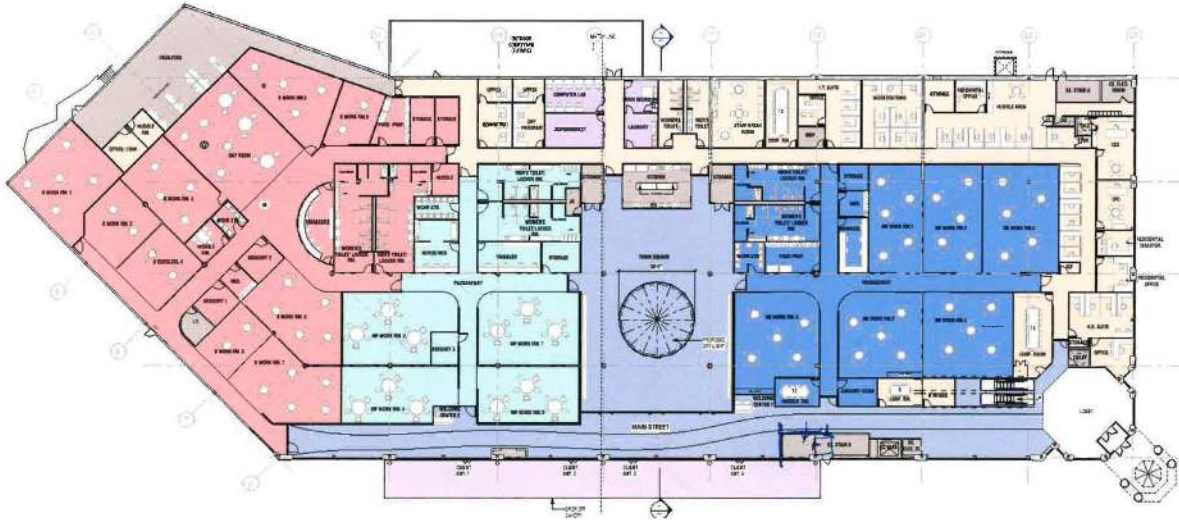

Top Floor

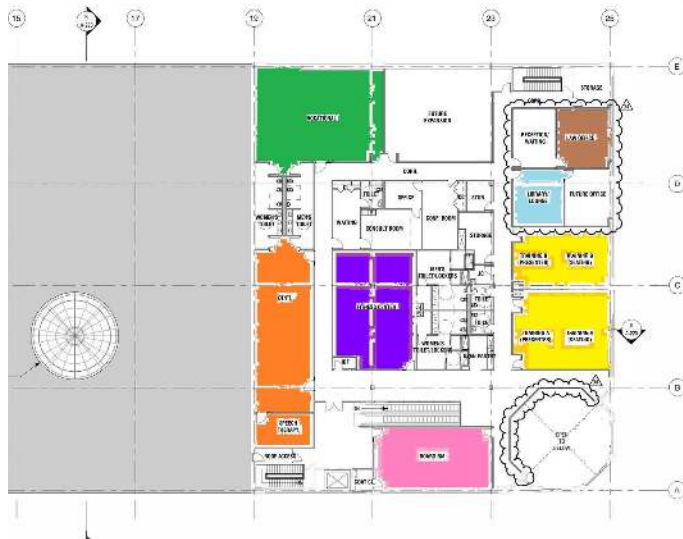

Naming Opportunities

Naming opportunities offer corporations or families the chance to contribute to a noteworthy chapter in NCFE's story, becoming an integral part of our lasting legacy. Your contribution will be prominently acknowledged in our new, cutting-edge Achievement Center.

The following pages list naming opportunities which can be paid in one installment or via a pledge for payment over several years.

Ground Floor:

- Behavioral Wing
- Medically Fragile Wing
- Town Square & Main Street
- Non-Behavioral Wing

Top floor:

- Vocational Training
- OT/PT/Speech Therapy
- Fitness Center
- Board Room
- Staff Training Rooms
- Library
- Legal Office

ACHIEVEMENT CENTER

TBD

81,423 Square Feet

Limited to one sponsor

Establish a legacy by securing the entire facility's naming rights for 5 years. When completed, this 81,423-square-foot multilevel center will house:

- Three Distinct Day Habilitation Programs (High-Need, Low-Need & Medically Fragile)
- 5,500 Sq. Ft. Community Center/Town Square
- Spacious Walking Paths
- Extensive Covered Drop-off/Pick-up Area
- Life Skills Training Rooms
 - Kitchen, Supermarket, Bedroom, Laundry, and Computer Lab
- Multiple Sensory Rooms
- Occupational Therapy
- Physical Therapy
- Speech Therapy
- Prevocational Training
- Wellness Suite
- Nurse's Suite
- Recreation & Fitness Space
- Two Staff Training Centers



ACHIEVEMENT CENTER

Area Stats:

Location: 765 Route 17 South, Paramus, NJ

Building Size: Approx. 81,423

Population

1 Mile 10,358

5 Miles 319,628

10 Miles 1,358,525

Average Daily Traffic - 138,000 vehicles



Occupying a prime location, this state-of-the-art and one of a kind facility boasts unparalleled visibility, capturing the attention of passersby and creating a commanding presence in Bergen County, NJ. Its strategic positioning ensures maximum exposure from both sides of Rte. 17 and its six acre lot stands out in the bustling landscape on Rte. 17.

The expansive windows and well-designed layout further enhance the property's visibility, allowing natural light to flood the space and showcase its features. This building is a true gem for those who value prominence and visibility in a premium setting.

BEHAVIORAL WING

\$375,000

14,002 Square Feet

Limited to one sponsor

INCLUDES:

- Naming rights for 5 years
- One large common area - approx. 1,450 square-footage
- Nine work rooms - approx. 7,467 total square-footage
- Two sensory rooms

Pink Area

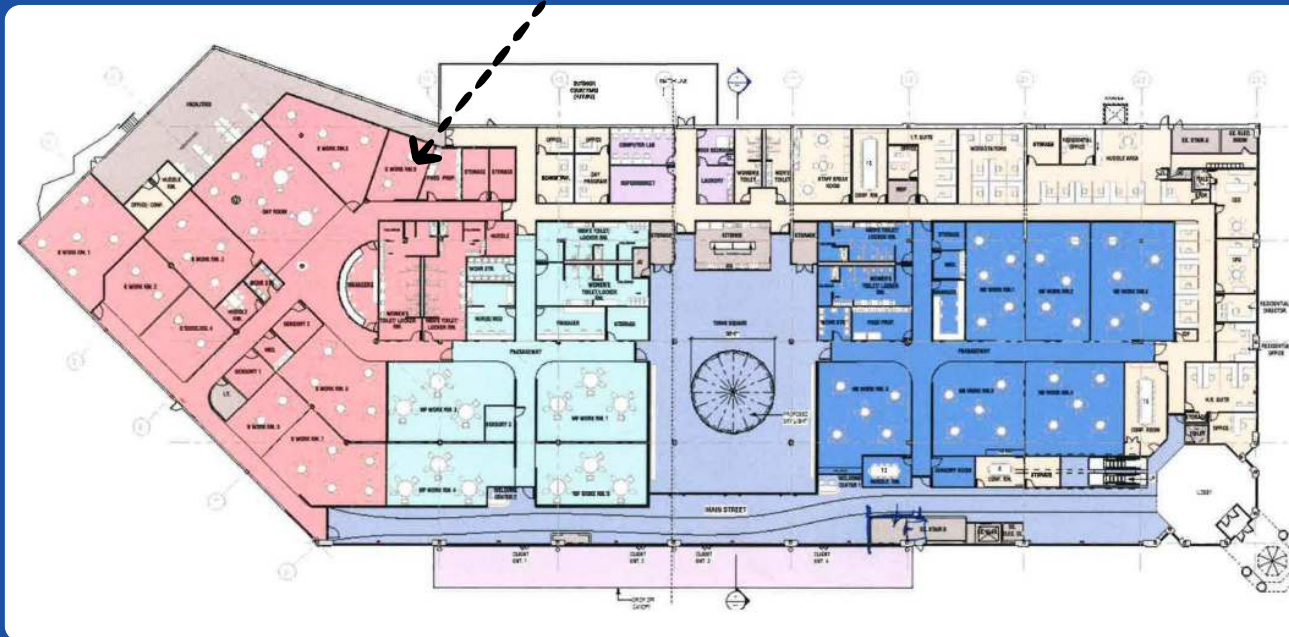

NON-BEHAVIORAL WING

\$275,000

10,528 Square Feet
Limited to one sponsor

INCLUDES:

- Naming rights for 4 years
- Six work rooms - approx. 6,050 total square-footage
- Sensory Room
- Huddle Room
- Food Prep Room

Blue Area

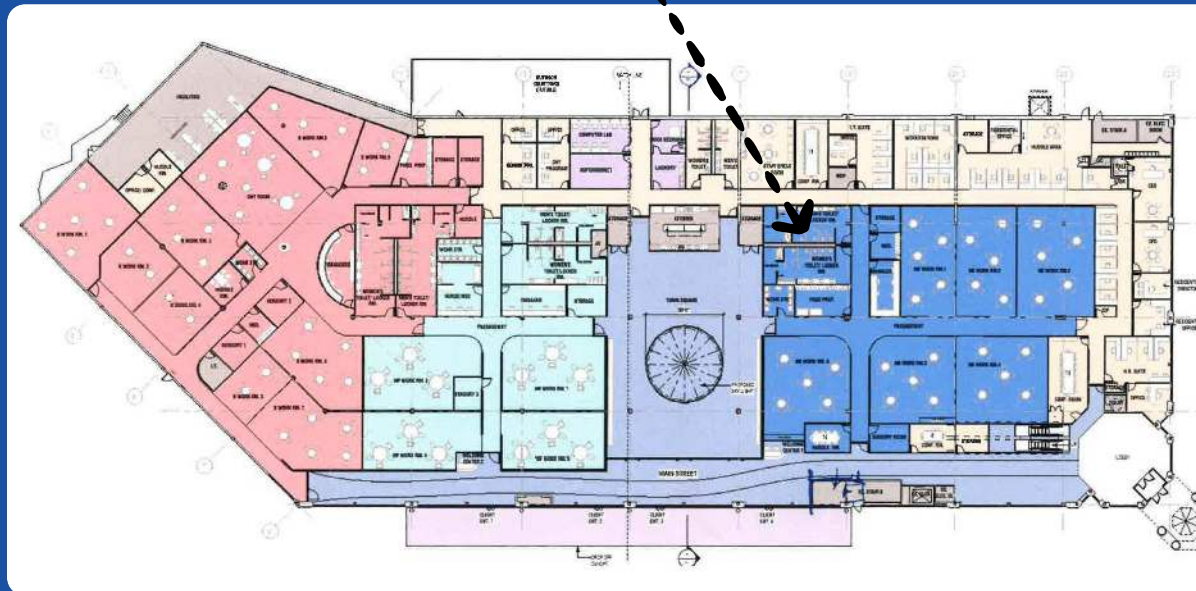

TOWN SQUARE

NCFL's Town Square sits in a premiere location on the lower level of the Achievement Center with 7,045 square feet of open space for client meetups, companywide gatherings, small/medium size events, etc. This area faces beautiful 'Main Street' where there are several entrances for clients and staff, and is surrounded by the Medically Fragile and Low-Need Wings.

Naming rights are for 4 years.

\$300,000
7,000+ Square Feet
Limited to one sponsor

Lavender Area

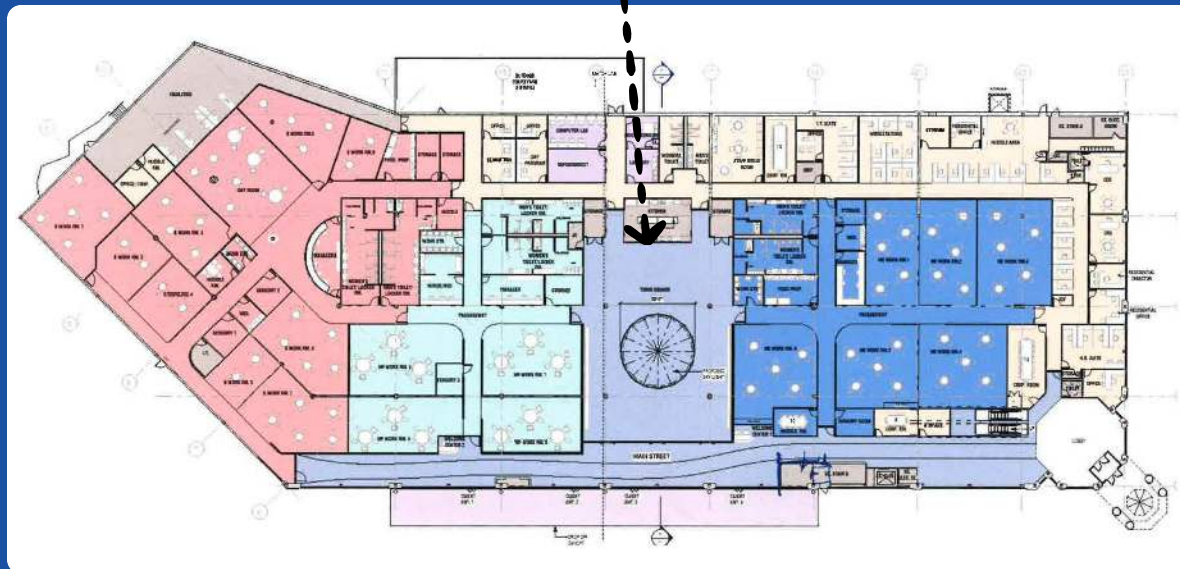

MEDICALLY FRAGILE WING

\$200,000

7,886 Square Feet
Limited to one sponsor

INCLUDES:

- Naming rights for 3 years
- Four Work Rooms - approx. 4,015 Total square-footage
- Nurses Office

Turquoise Area

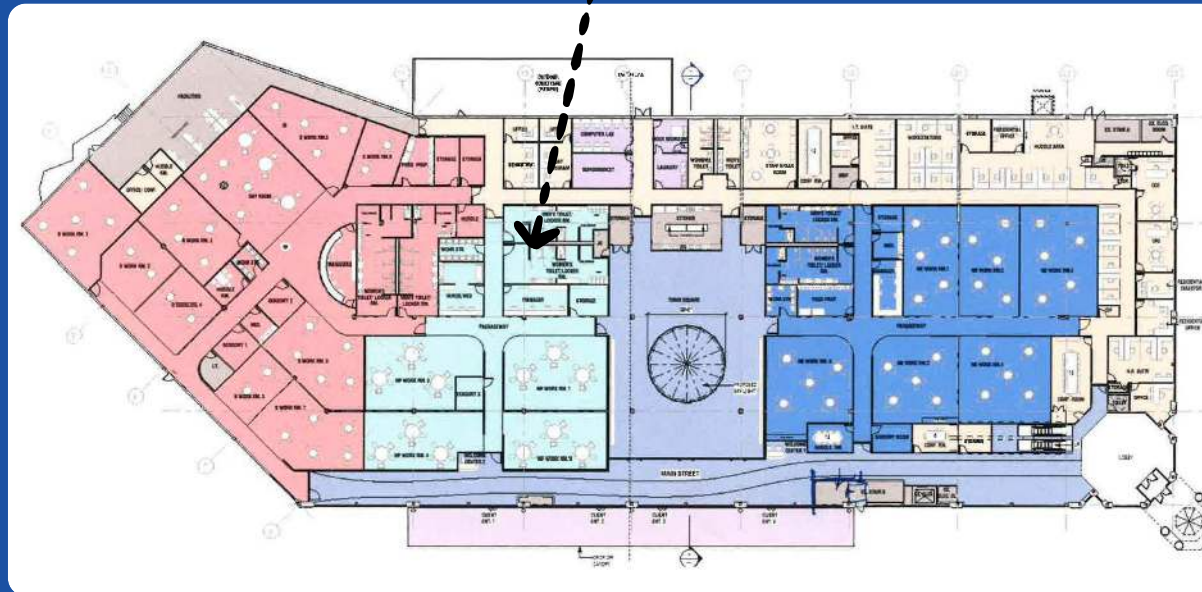

Additional Naming Opportunities

(All naming rights \$125k and above are for 3 years; below \$125k are for 2 years.)

Lobby and Welcome Area
\$200,000

Board Room
\$150,000

Conference Room
2 @ \$150,000

Kitchen
\$125,000

Computer Lab
\$125,000

Supermarket
\$125,000

High-Need
Work Rooms
9 @ \$100,000/ea

Medically Fragile
Work Rooms
4 @ \$100,000/ea

Low-Need
Work Rooms
6 @ \$100,000/ea

Fitness Center
\$75,000

Staff Training Room
\$75,000

Low-Need
Sensory Room
\$75,000

High-Need
Sensory Room
2 @ \$75,000/ea

Medically Fragile
Sensory Room
\$75,000

Laundry or Bedroom
Life Skills Rooms
\$75,000

Digital Donor Wall

All donations at \$25,000 and above will also receive annual recognition on a "Digital Donor Wall" located within the Achievement Center.



New Concepts for Living

*Providing a Lifetime of Care
for Extraordinary People*

Community
Residences
(Group Homes)



Medically
Supportive
Community
Residences



Achievement
Center
(Day Program)



Behavioral
& Nursing
Services



Be part of our family...

Where extraordinary people thrive.

For more information please call Sharon Scimeca, Director of Development at 551-733-6349 or via email at sscimeca@ncfl.net

“Joey has been attending NCFL’s day program for 15 months now; it’s been a great adult transition for him. It is wonderful as parents to know he is safe and happy creating wonderful memories each day. I see this each afternoon at pickup time when Joey’s friends assist the staff in leading him out of the workrooms - the bond he’s created with other clients is amazing. It warms a mom’s heart to hear other clients and staff cheer his name to greet him.

We love the opportunities he’s had in the community with the numerous outings and the accessibility of wheelchair vans that are always available for him. With full time nurses in the program and Joey’s medical needs, it also adds to the reassurance that he is in good hands. As a family we always feel welcome at their many events. They offer a full calendar of activities for life skills and academic skills to be sharpened, as well as art, dance and music to keep him well rounded. We are blessed to have the NCFL family be part of ours!”

Kim C. - Joey’s Mom